

CRANKCASE, CRANKSHAFT AND CAMSHAFT GROUP

CRANKCASE RELATED PARTS

FIG. REF.	PART NUMBER	DESCRIPTION	ON ALL	QUANTITY PER ASSEMBLY															
				J1A5D	J2A5D	J3C5D	L3C5D												
3																			
1	1028-B	BALL, 11/16 dia.	1																
2	68668*	SPRING, Oil pressure relief valve	1																
	61084*	SPRING, Oil pressure relief valve	1																
	77467*	SPRING, Oil pressure relief valve	1																
	LW-11713*	SPRING, Oil pressure relief valve	1																
3	STD-425	WASHER, Plain, no. 10 (Max. 9)			un	un	un												
4	STD-1045	GASKET, 1/4 ID x 1-1/2 OD x 3/32 ann.	1																
5	76529	PLUG, Oil relief valve				1	1	1											
6	77808	VALVE ASSY., Oil pressure relief, adjustable															1		
7	LW-15278	BEARING, Crankshaft	6																
8	LW-13884	BEARING, Crankshaft front	2																
9	LW-13792	SEAL, Crankshaft oil	1																
10	72091	RING, Oil seal, 23/64 ID x 7/64 dia. section	2																
11	72877	BODY, Hydraulic tappet	12																

* - Select spring that gives desired oil pressure using a minimum number of washers on the -J engines; select spring to give a minimum of three threads exposed on adjusting screw to allow field adjustment on -L engine.

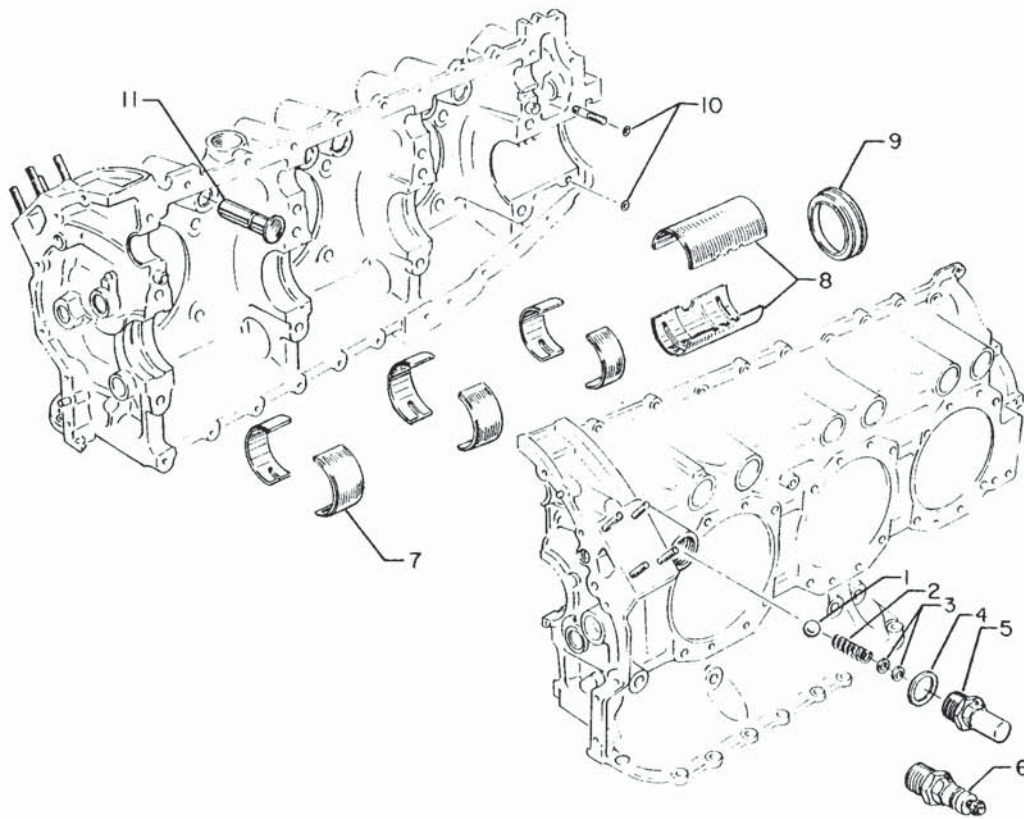

Figure 3